

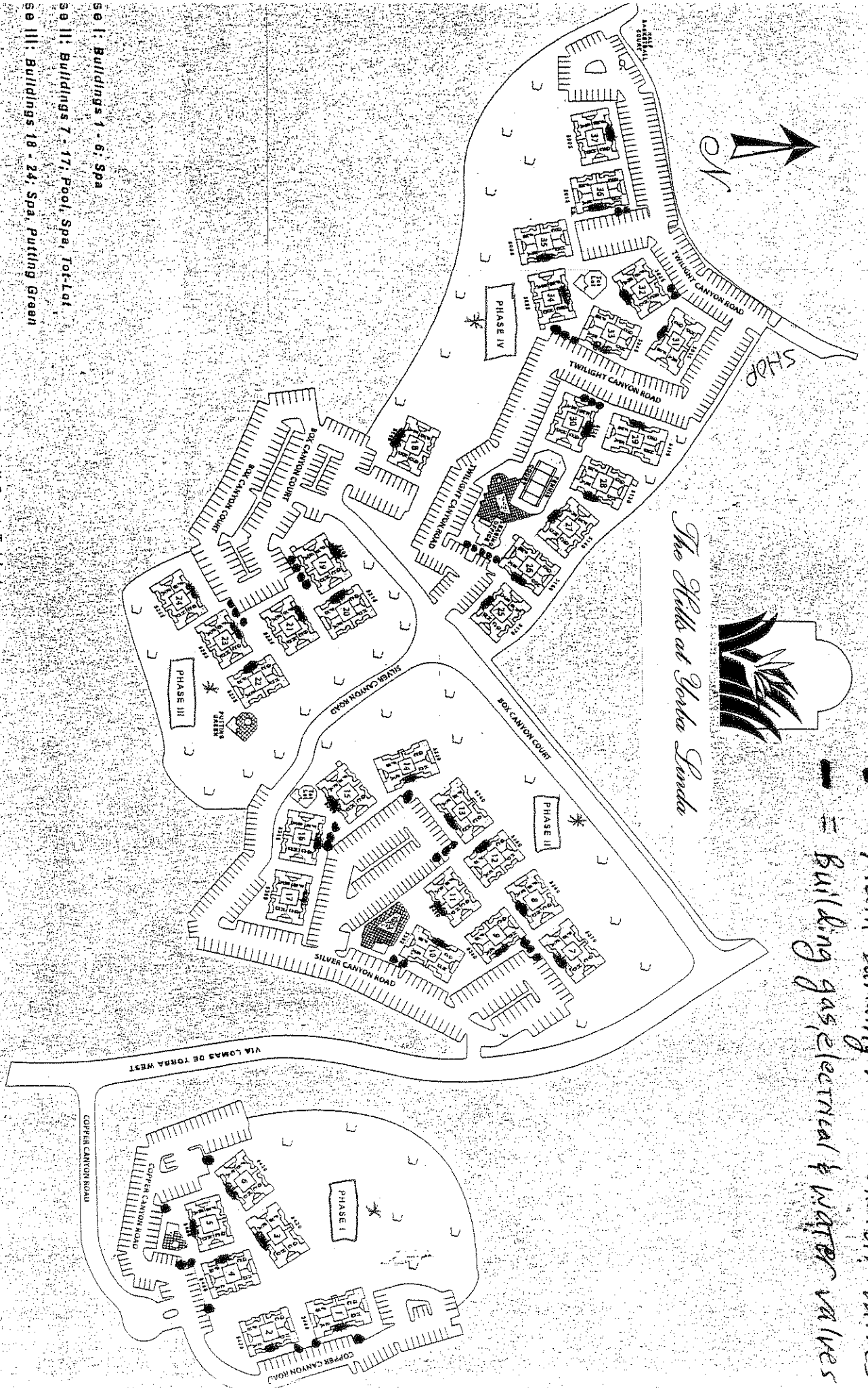

*The Villas at Santa Linda*

- Main building water shutoff valves
- Building gas, electrical & water valves



- so I: Buildings 1 - 6; Spa
- so II: Buildings 7 - 17; Pool, Spa, Tot-Lot
- so III: Buildings 18 - 24; Spa, Putting Green
- so IV: Buildings 25 - 37; Pool, Spa, Tennis Court, Half Basketball Court, Tot-Lot

37c